

## CD009 Sequential Cam Installation

This upgraded shift cam will decrease shift effort by around 15% and prevent over rotation of the selector shaft that some gearboxes experienced. This is done by eliminating the dwell in the centre of travel a feature that had been introduced for earlier t56 variants of the shifter that required this.

This cam is to be fitted to both the short and long type cd009 shifters. All shifters delivered after 6<sup>th</sup> October 2021 will be fitted with this standard.

The Revised cam identified below can be recognised by the small drill mark



### Installation process

1. Remove side cover by undoing the 4x 5mm bolts



## 2. Remove slider plate



3. Undo cam using a piece of aluminium to stop rotation of the cam. Do not use the internal parts of the shifter to stop rotation and please use a proper hex tool to do this and not an allen key as the bolt will be very tight.



4. Fit new cam using an aluminium block to prevent rotation again and tighten bolt, Care must be taken to have the cam mounted in the same position as it originally was. If this shifter is in first gear the high lift part of the cam should be facing the rear of the shifter.



5. Refit slider plate and plastic shim .



6. Refit side cover

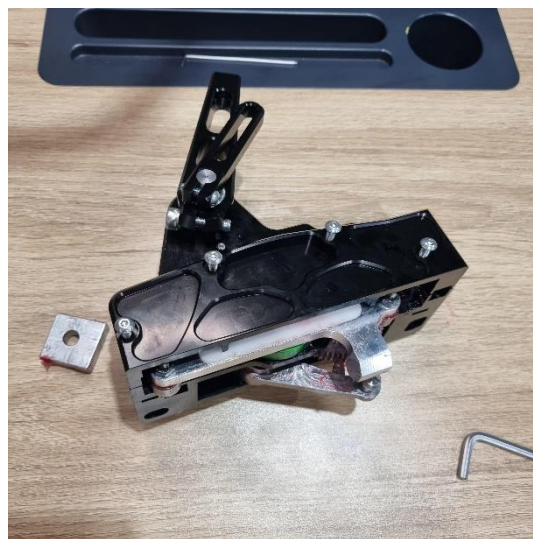

Check for updated shifter instructions in tech help section of website